

# Safety shut-off Valves series VSC

Gas safety solenoid shut-off valve series VSC are manufactured in conformity to the Norm EN 161 and are suitable for the automatic control of gases belonging to the first, second and third family.

These valves, normally closed for continuous and cyclic operation, open by powering the coil and close quickly when there is no tension.

They are in conformity to regulation EU 2016/426 and SIL 2 and 3 (with 2 solenoid valves and tightness control).



## TECHNICAL FEATURES

<b>Body valve</b>	Aluminium
<b>Connections</b>	Rp 1/2
<b>Max Inlet pressure</b>	200 mbar and 1 bar
<b>Opening/Closing Time</b>	< 1 second
<b>Standard supply voltage</b>	230V ac
<b>Frequency</b>	50 ÷ 60 Hz
<b>Enclosure</b>	IP 65 - IEC 529
<b>Duty cycle</b>	Continuous 100%
<b>Ambient temperature</b>	-20 ÷ +60 °C

## FEATURES

- Class A, Group 2 according to EN161
- Normally closed
- Quick opening and closing
- Polyammidic resin encapsulated coils
- Quiet operation

## DIMENSIONS AND MODELS

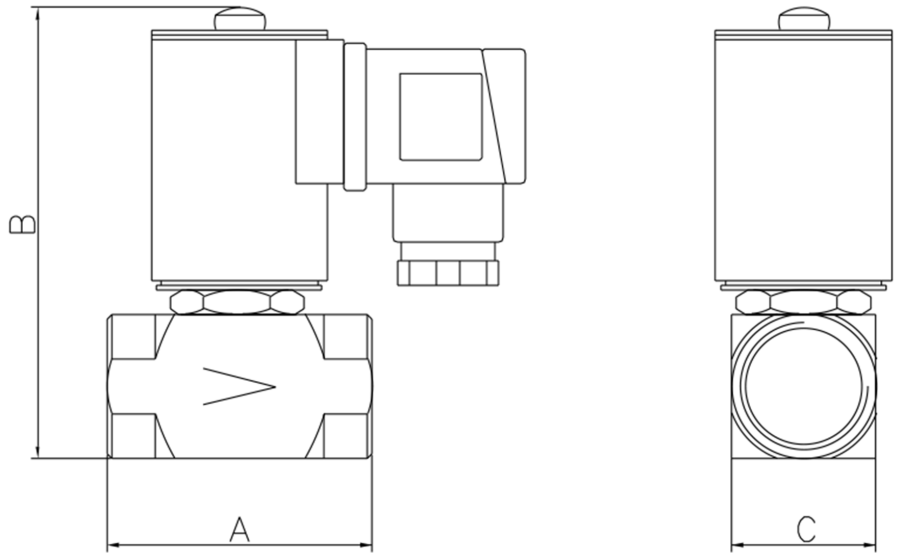

Connection	Max pressure (mbar)	Rating at 230V (VA)	Dimension (mm)			Weight (Kg)	Code	
			A	B	C		Whit max. flow adjustment	Whitout max. flow adjustment
1/2"	200	9	55	90,50	37	0,6	VSCR215C	VSCR215C
1/2"	1000	18	50	100,30	30	0,6	VSCR1015C	VSCR1015C

## FLOW CHART

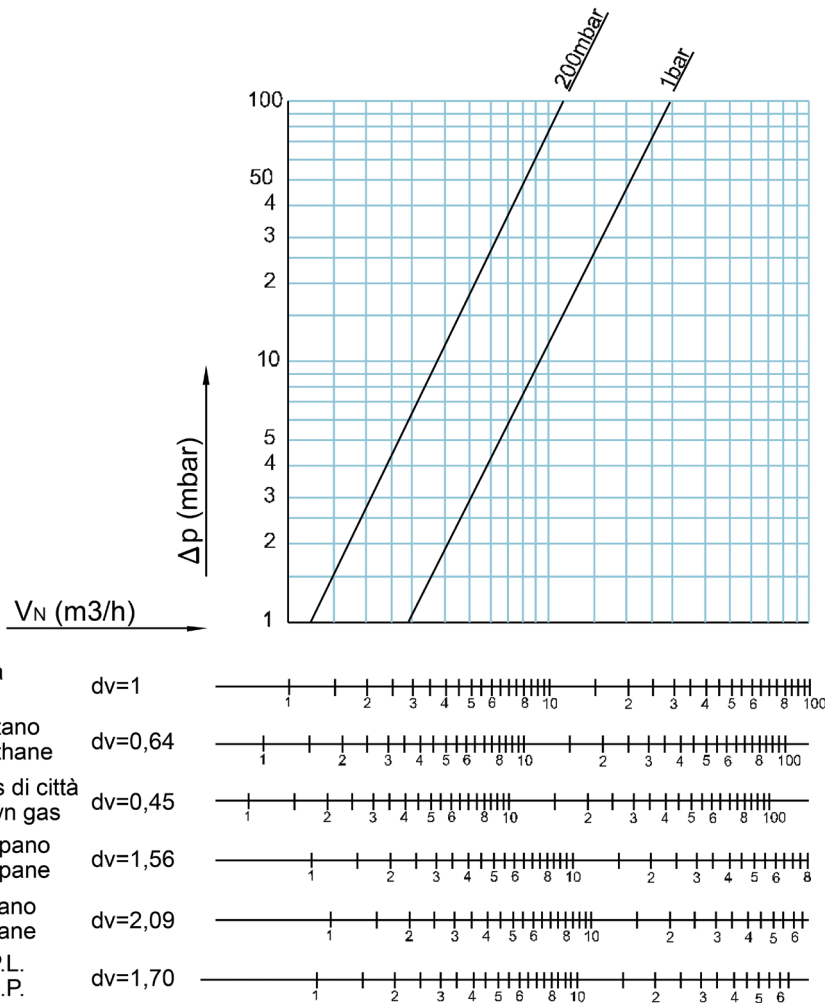

The data is subject to change without notice.

form 180911

**econex**

Econex s.r.l. - Via Francesco De Sanctis, 53 - I-20141 Milano  
 Tel. +39 0289502912 - Fax +39 028463084 - www.econex.it - info@econex.it